

Latching Relay TRW5

MAIN FEATURES

- Maximum switching capability up to 50A.
- Lamp load up to 5000W.
- Capacitor load up to 200uF. (Min. inrush current at 500A/ 10s)
- Creepage distance: 8mm
- Dielectric strength: more than 4000VAC. (between coil and contacts)
- Wash tight and flux proofed types available.
- Manual switch function available.



APPLICATIONS

- Electricity Meter.
- Ripple Control receiver.
- Time Switches.
- Lighting Control.

ORDERING INFORMATION

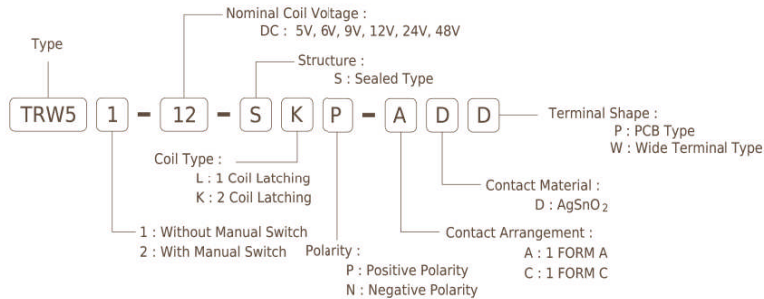

DIMENSION(unit:mm)

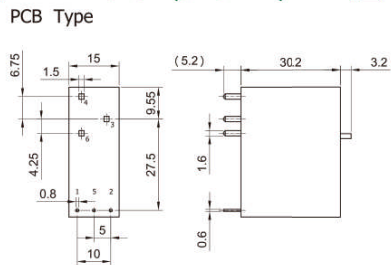

Wide Terminal Type

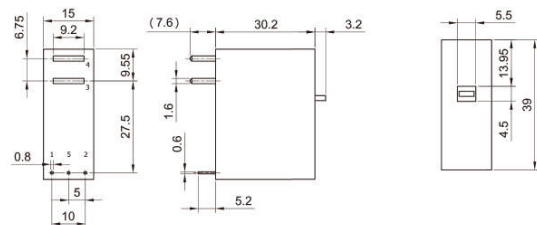

DRILLING(unit:mm)

WIRING DIAGRAM

1 FORM A (Positive Polarity)

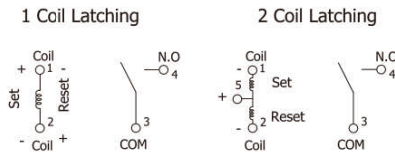

1 FORM C (Positive Polarity)

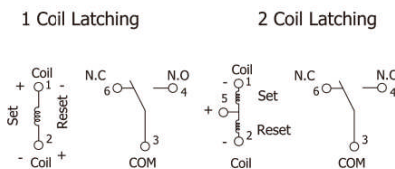

COIL DATA CHART(at 20°C)

TRW5 -L Type (1 coil latching)				
Coil Voltage (VDC)	Set/Reset Voltage (VCD)	Coil Resistance (Ω) ±10%	Coil Power (W)	Max Allowable Voltage (VDC)
5	4	16.8	1.5	6.5
6	4.8	24		7.8
9	7.2	54		11.7
12	9.6	96		15.6
24	19.2	384		31.2
48	38.4	1536		62.4

TRW5 - K Type (2 coil latching)				
Coil Voltage (VDC)	Set/Reset Voltage (VCD)	Coil Resistance (Ω) ±10%	Coil Power (W)	Max Allowable Voltage (VDC)
5	4	8.4+8.4	3.0	6.5
6	4.8	12+12		7.8
9	7.2	27+27		11.7
12	9.6	48+48		15.6
24	19.2	192+192		31.2
48	38.4	768+768		62.4

CONTACT RATING

Item	TRW5	
	1 Form A	1 Form C
Contact Rating (Res. Load)	50A 277VAC 5000W 240VAC 5HP 250VAC	40A 277VAC
Max. switching voltage	440VAC	
Max. switching current	50A	
Max. switching power	12500VA	10000VA
Contact material	Silver Alloy	
Mechanical endurance	1 x 10 ⁶ ops	

PERFORMANCE(at initial value)

Item	TRW5
Contact Resistance	50mΩ (at 1A 24VDC)
Creepage Distance (input to output)	1A : 8mm 1C : 6mm
Pulse width of coil	50ms min. (Recommend: 100 to 200ms)
Operation Time(at nomi. Volt.)	15msec.
Release Time (at nomi. Volt.)	15msec.
Max. operate frequency	1A : 20cycles/min. 1C : 10cycles/min.
Dielectric Strength	Between open contacts : 1500VAC (1 minute) Between coil & contacts : 4000VAC (1 minute)
Shock Resistance	Functional : 98m/s ² Destructive : 980m/s ²
Vibration Resistance	D.A. : 1.5mm 10 to 55Hz
Humidity	98% RH, +40°C
Temperature Range	-40 to +70°C
Termination	PCB, QC
Weight	Abt. 32g.

NOTICE

- Relay is on the "reset" or "set" status when being released from stock, with the consideration of shock risen from transit and relay mounting, relay would be changed to "set" or "reset" status, therefore, when application (connecting the power supply), please reset the relay to "set" or "reset" status on request.
- In order to maintain "set" or "reset" status, energized voltage to coil should reach the rated voltage, impulse width should be 5 times more than "set" or "reset" time. Do not energize voltage to "set" coil and "reset" coil simultaneously. And also long energized time (more than 1 min) should be avoided.
- In order to avoid changing operate voltage, products should not be kept in strong magnetic field during transportation, storage and application.

1.Tolerance ±0.5mm on all dimensions unless otherwise stated.
2. Tolerance ±0.1mm on PCB DRILLING dimension unless otherwise stated.